

Devolinx STE-501C/502C

1/2-Port Ethernet Serial Server



Features

- ▶ Rugged Metal Case with DIN-Rail / Wall-Mount
- ▶ 15 KV ESD Protection for Serial Signals
- ▶ 10/100Mbps Fast Ethernet Full Duplex Auto Negotiation
- ▶ Supports Multiple Link Mode with TCP Server/Client, UDP, and Virtual COM Mode
- ▶ Monitor, Manage, and Control Industrial Field Devices Remotely
- ▶ Configurable via Built-In Web Server, Serial Console, or Telnet
- ▶ Windows Base Utility for IP Configuration
- ▶ Compact Size
- ▶ Upgradeable Firmware from Remote-PC via Ethernet



▶ Specifications

STE-501C

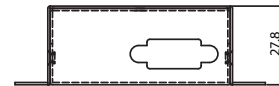
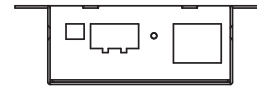
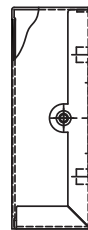
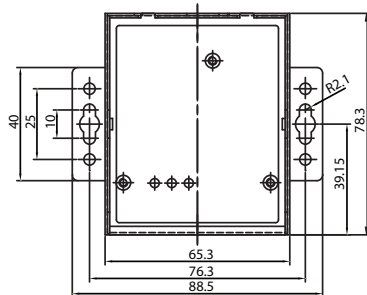

STE-502C

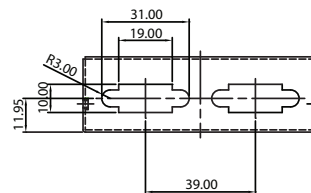
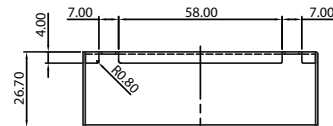
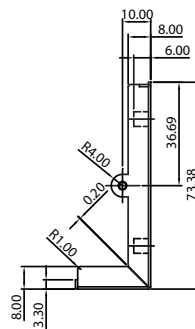
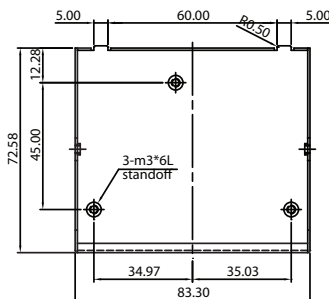

► Specifications

CPU

16-bit Embedded CPU

Flash Memory

512 KBytes

SDRAM

512 KBytes

EEPROM

512 Bytes

Network Interface

10/100Mbps Fast Ethernet

Network Protocol

TCP/IP, UDP, HTTP, SNMP, ARP, Telnet, ICMP, BOOTP, DHCP

Reset

Built-In Reset Key to Restore Defaults

Serial Interface

RS-232/422/485

Serial Connector

DB9 Male

Serial Communication

Data Rate: 1200 ~ 230400 bps (230Kbps)

Characters: 7 or 8 Data Bits

Parity: None, Even, Odd, Mark, Space

Stop Bits: 1 or 2

Flow Control: Xon/Xoff, RTS/CTS

LED Indicators

LAN, RUN, and COM

Software

Windows OS Based Configuration Utility, Virtual COM Software

Configuration

Web (HTML), Telnet, Serial Console, and Configuration Utility

Power Requirement

9 ~ 30VDC

Power Consumption

3 Watts

Operation Temperature

0° C to 60° C (32° F to 140° F)

Storage Temperature

-20° C to 85° C (-4° F to 185° F)

Operation Humidity

20% to 90% (Non-condensing)

Dimension (W x H x D)

STE-501C: 65 x 80 x 28 mm (2.56 x 3.15 x 1.10 in.)

STE-502C: 85 x 75 x 28 mm (3.35 x 2.95 x 1.10 in.)

Approvals

FCC, CE

Warranty

5-Year Warranty

► Comparison

| Model | STE-501C | STE-502C | STE-601C | STW-601C |
|------------------|------------|------------|--|--|
| Number of Ports | 1 Port | 2 Ports | 1 Port | 1 Port |
| Case Design | Commercial | Commercial | Industrial | Industrial |
| Flash Memory | 512KB | 512KB | 512KB | 10MB (2MB for Bootloader) |
| SDRAM | 512KB | 512KB | 512KB | 32MB |
| Wireless LAN | No | No | No | Yes |
| Serial Connector | DB9 Male | DB9 Male | DB9 Male 5 Pin Terminal Block 8 Pin Mini-DIN | DB9 Male 5 Pin Terminal Block 8 Pin Mini-DIN |

► Ordering Information

STE-501C

1 Port Ethernet Serial Server, RS-232 / 422 / 485, DIN-Rail/Wall-Mountable

STE-502C

2 Port Ethernet Serial Server, RS-232 / 422 / 485, DIN-Rail/Wall-Mountable

*** POWER ADAPTER SOLD SEPARATELY ***

Optional Accessories

PA-STX-US

Power Adapter for STE-501C (USA)

PA-STE502-US

Power Adapter for STE-502C (USA)

PA-STX-EU

Power Adapter for STE-501C (Euro)

PA-STE502-EU

Power Adapter for STE-502C (Euro)

DIN-RAIL-KIT

DIN Rail Mounting Kit

Antaira Technologies

Toll-Free: (877) 229-3665

Phone: (714) 671-9000

FAX: (714) 671-9944

e-Mail: info@antaira.com

Website: <http://www.antaira.com>

www.antaira.com